

Temperature measurement face recognition peer management module

Temperature measurement face recognition peer management module, using a high-performance hardware platform, equipped with an industrial-grade binocular camera and face biometric recognition technology, as well as an infrared thermal imaging module. Supports 1:1 and 1:N face matching and retrieve, Support mask recognition and human temperature detection, it can warn against high temperature, and supports expansion of various peripherals such as ID card reader, fingerprint reader, etc. It can be applied to gate passages and access control attendance to achieve safe and efficient access control for personnel.



Suitable for many occasions



Multiple connection modes

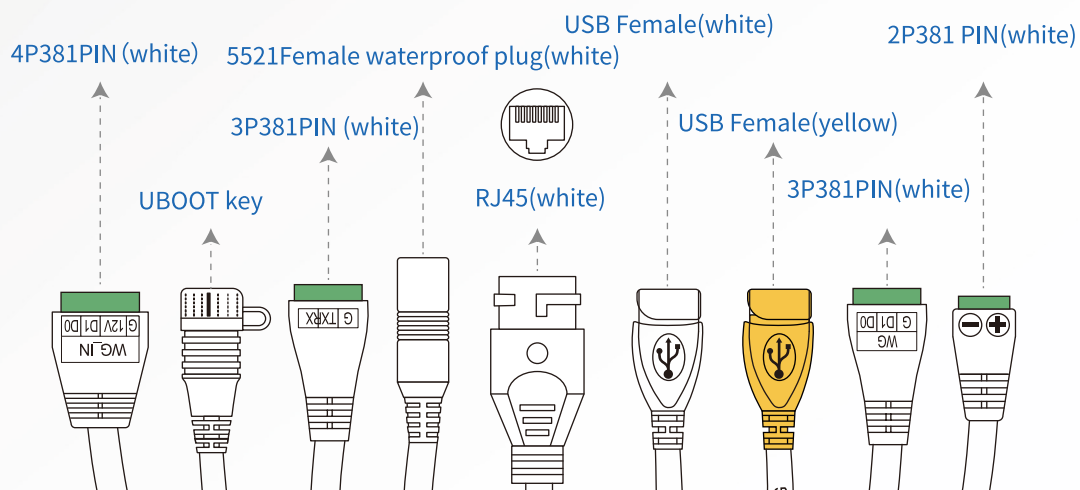

Product parameters

Camera	Resolution	200W pixels	
	Type	Binocular wide dynamic camera	
	Aperture	F2.4	
	Focal length	50-150cm	
	White balance	Automatic	
	Fill light	LED and infrared double fill light	
Panel	Dimension	8.0 inch, IPS LCD screen	
	Resolution	800x1280	
	Touch	Support (support or not is optional)	
Properties	Local storage	EMMC 8G	
Infrared thermal imaging module	Body temperature detection	Support	
	Detection distance	1m	
	Measurement accuracy	≤ ±0.2°C	
	Measurement range	10°C~42°C	
	Thermal imaging field	32 X 32°C	
	Normal temperature release	Support	
	High temperature alarm	Support (alert value can be set)	
Infrared thermal imaging module	Protection grade	Ip65, Limited outdoor dust and water resistance	
	Power	DC12V (±10%)	
	Working temperature	-10°C~60°C	
	Storage temperature	-20°C~60°C	
	Power consumption	13.5W (Max)	
Infrared thermal imaging module	Machine*1, Power Adapter*1, Instruction manual*1, Certificate of qualification*1, Support detection and tracking		
Function	multiple people at the same time, ,Face database supports up to 30,000		
	Support 1: N face recognition, 1: 1 face contrast		
	Support configuration of stranger detection and recognition distance		
	Support UI interface configuration, equipment remote upgrade		
	Interfaces include device management, personnel / photo management, record query, etc.		
	Support for public cloud deployment, privatized deployment, LAN		
Input output	WIFI×1, Audio×1, USBOTG×1, USB HOST×1, RS232x1, relayx1, upgrade button×1, RJ45x1		
Structure	Installation method	Gate bracket installation	Wall mount bracket installation
	Device dimension (standard models)	271.24*128*21.48 (mm)	271.24*128*21.48 (mm)
	Device dimension (with swipe function)	293.18*132.88*25 (mm)	293.18*132.88*25 (mm)
	Weight	1.45kg	1.05kg

Wall mount

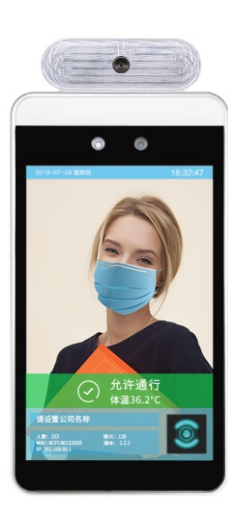

Standard models

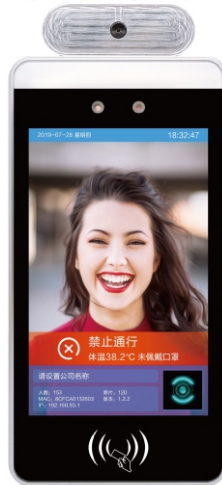

IC card / ID card

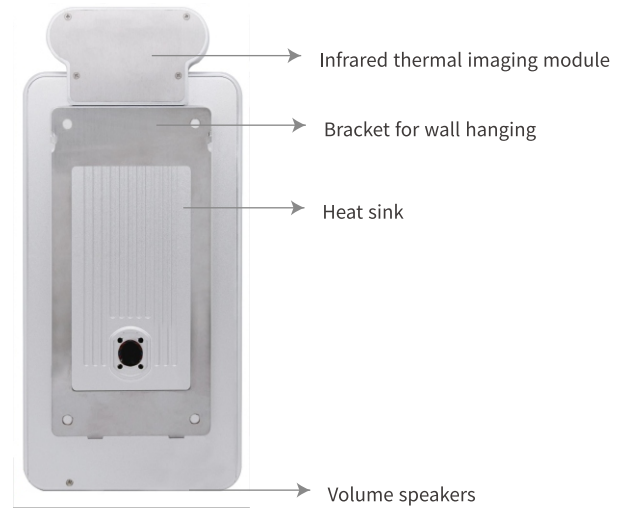

Installation Notes

Step 1. Mark the 4 fixing holes of the wall mounting bracket on the pre-installation wall; Drill the hole and fix the plastic expansion bolt to the wall positioning hole at once.

Note: The wall-mounted fixing plate is recommended to be 1.35 meters away from the ground floor.

Step 2. Fix the wall mount bracket to the wall bracket with four countersunk head tapping screws.



Step 3. Fix the module on the hook of the wall mount bracket, and fix the azimuth hole under the device with the combination screw below.

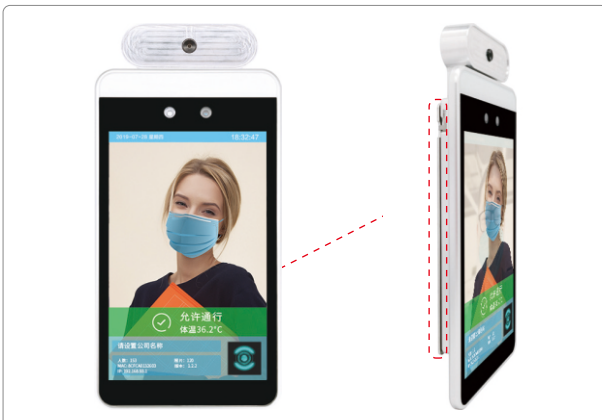

Bracket installation



Standard models

IC card / ID card

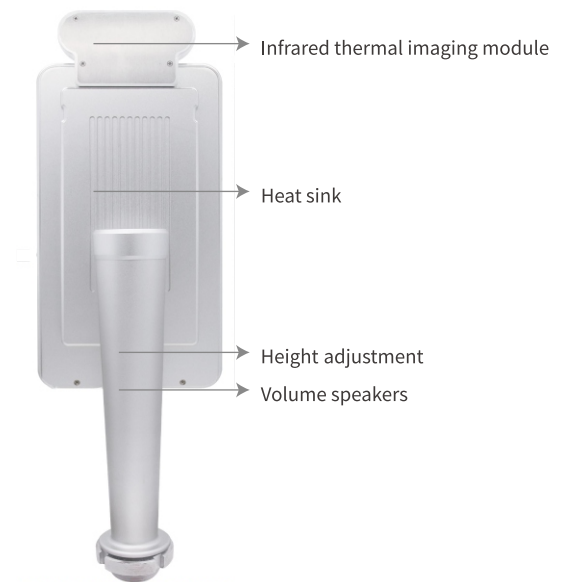

Installation Notes

Step 1. According to the requirements of the installation site, drill a 35mm diameter hole in the space position of the gate (normally the middle or front side). (As the picture shows)

Note: The opening position should be based on the actual gate type and site conditions, and 35mm is only a reference value.

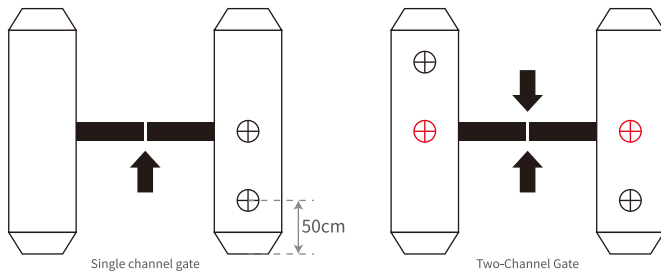

Step 2. Unscrew the nut at the bottom of the gate pillar, pull the cable out of the nut, and remove the nut.



Step 3. Under the gate, pass the cable and the cable interface through the gasket and the nut in turn, tighten the nut, connect the power, and the screen will start.



Maintenance

1. During the installation and use of the product, it is necessary to strictly observe the national and regional electrical safety regulations.
2. Please use the power adapter provided by the official manufacturer. The specific requirements of the power adapter refer to the product parameter table.
3. Make sure the product is securely installed when the machine is installed on the gate.
4. If the product behaves abnormally, please contact the after-sales service staff. Do not disassemble or modify the product in any way. (The company does not assume any responsibility for problems caused by unauthorized modification or repair).
5. Do not immerse the product in water. When installing it outdoors, try to use it with the rain cover provided by our company.
6. Please understand that you are responsible for properly configuring all passwords and other related product security settings, and keeping your username and password.
7. If the equipment does not work properly, please do not disassemble it for repair by yourself, otherwise it will affect the equipment warranty.
8. Avoid extreme or extreme environments such as extreme high temperature (or low temperature), high humidity, vibration, radiation, and chemical corrosion during installation and use.

Warranty card

Dear customer, thank you for purchasing the Face Recognition Communication Management Module. In order to serve you better, please read, fill out and properly keep this warranty card after purchasing the product.

Client's name	
Contact person	
Telephone	
Address	
Purchase date	
Serial number	
Malfunction reason	

Warranty Instructions:

1. Please keep this warranty card for servicing vouchers.
2. This product is guaranteed for 1 year from the date of purchase.
3. During the warranty period, if the machine book fails under normal conditions of and maintenance, it is verified that the company will provide free maintenance and replacement of parts.
4. During the warranty period, if the following issues occur, the company has the right to refuse service or charge materials and repair service fees at its own discretion.
 - 1). This warranty card and valid proof of purchase cannot be provided.
 - 2). Improper use may cause product failure and damage.
 - 3). Damage due to abnormal external forces.
 - 4). It is not our maintenance service, and it is damaged by user's own disassembly.
 - 5). Failure and damage caused by natural disaster or other force majeure factors.
 - 6). Others are intentionally damaged.
5. The company reserves the right to modify and interpret all content.